

<sup>1)</sup> Torx is a registered trademark of Camcar Textron  
WBT is a registered trademark of WBT GmbH

Table of contents		
1	Base element Cu alloy	1
2	Adjusting nut Cu alloy	1
3	Compression pad Cu alloy	1
4	Locking screw, Cu alloy M1,6 x 3 DIN 84	1
5	Double step washer, PA with square socket and tappet, red, white or black	1
6	Marking ring, PA red, white or black	1
7	Insulating puzzle lock washer, PC, black	1
8	Torx <sup>®</sup> screw, Ms M4 x 7	1
9	Counternut, Ms	1
10	Optional fan-shaped washer, Bz (WBT-9150)	1
Extent of delivery: 1 to 9 (10 optional) enduser version: 1-6, 8+9 mounted OEM version: 1 to 4, 6 mounted		
Revision date 14.08.2007		

### WBT- 0702.01 Topline High Current Pole Terminal (US Patent No. 5,226,841)

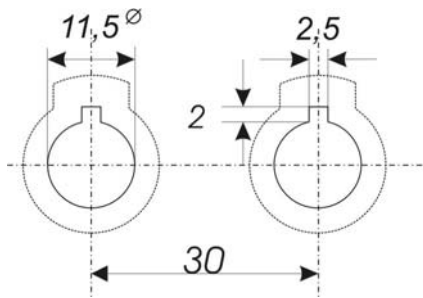

Drilling scheme (original size)



- Mechanics**
  - single-segment, low-tolerance contact elements (tol. less than  $\pm 0.02$  mm)
  - solid basic element with 4-mm boring and collet chuck for banana plug and internal screw box with cross boring for direct cable connection.
  - Adjusting nut with fine thread for optimum contact pressure
- Materials**
  - all solid parts made of highly ductile copper alloy
  - insulating material: polyamide PA 6 (10% glass fibre), red, white or black polycarbonate PC (30% glass fibre), black
- Surfaces:**
  - 24 k multilayer gold plating (Au 0.3  $\mu$ m), Ni-free, non-magnetic
- Operating characteristics**
  - continuous current  $I_0 \geq 100$  A
  - peak current  $I_S \geq 300$  A
  - contact resistance  $R_0 \leq 0.1$  mOhm
  - volume resistance  $R_B \leq 0.003$  mOhm
  - isolation resistance  $R_{iso} > 10^{10}$  Ohm
- Outlines**
  - length, over all: L = 58 mm
  - overhang,  $L_0 = 32.9$  mm
- Connection options**
  - Internal connection (for cables up to 10 mm<sup>2</sup> (AWG 7)):
    - soldering version
    - crimping version
  - external connection:
    - for (crimped) cable ends up to 6 mm<sup>2</sup> (AWG 9)
    - for spade lugs (with 6- and 8-mm contact fork)
    - for 4-mm banana plugs
- Mounting**
  - single: boring: dia. 11.5+0.2 mm with 2.5x2 nut for twist protection (see drilling scheme left)
  - as double pole terminal with recommended spacing of 30mm as shown left
  - Recommended tightening torque for the counter nut (9): 8.5 Nm

WBT also offers special parts and information hereto. Please ask us!  
**New:** WBT mounting plates made of aluminium, mono- and bi-wiring plates equipped with WBT terminals are also available.

**Safety instruction:** within the EU territory WBT-0702 must not be used without the safety-stick (WBT-0799) (to provisionally close the 4-mm banana-boring).